

# The Lighting



# Lighting Plan

*Modern Style,  
Monochromatic Green*



**Switch, Dimmer & Plug - in**

*Plug – in at Countertop, Living  
Room, Bedroom and Den are  
with USB as well*

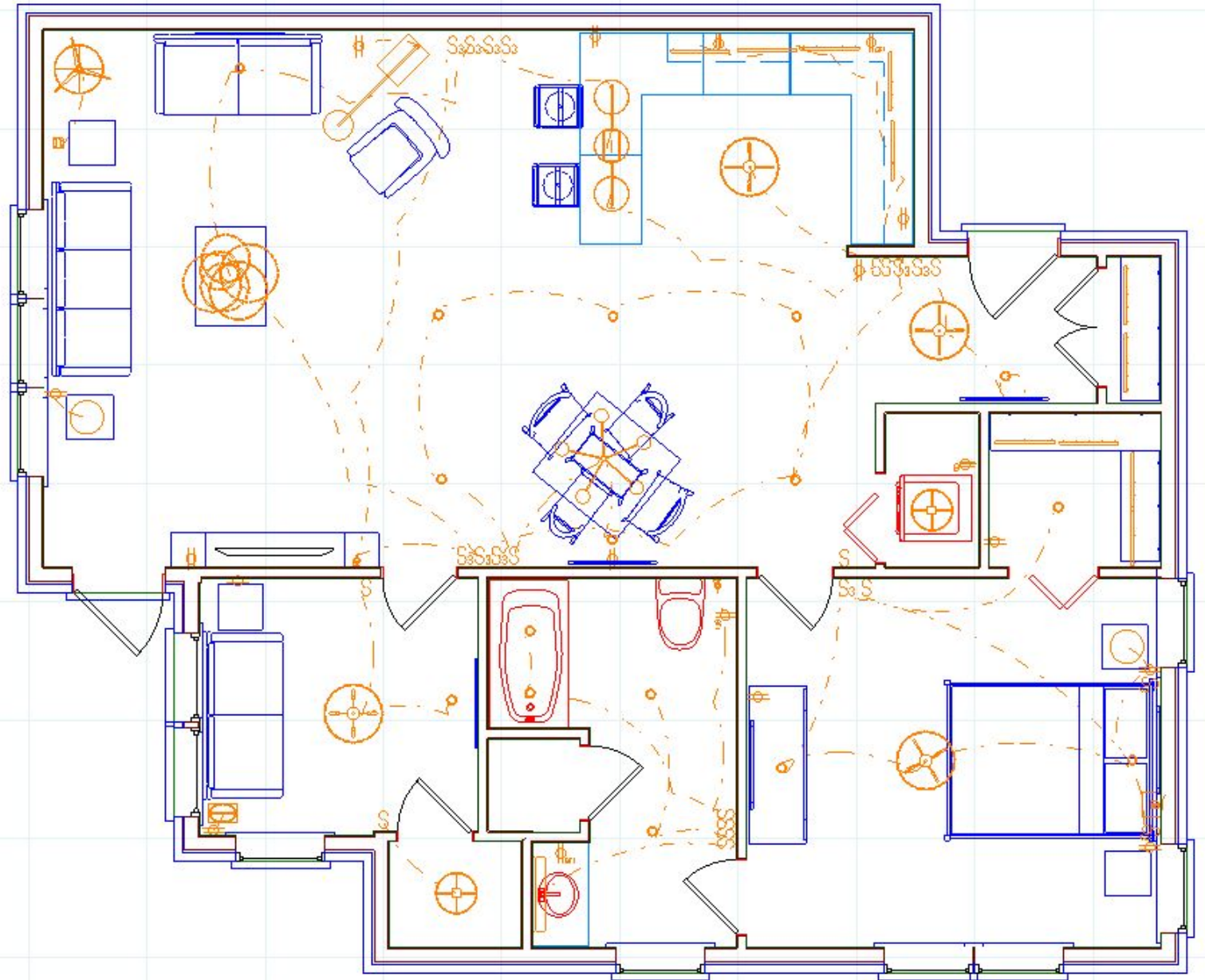

# Foyer - Entrance

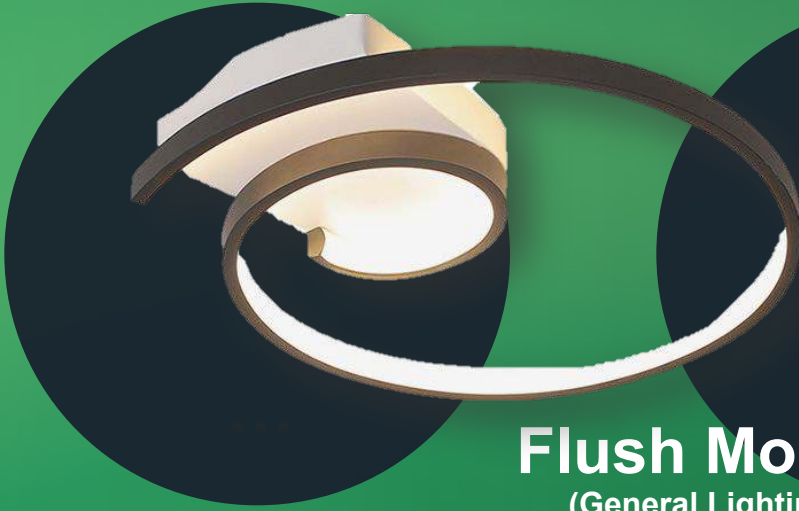

**Flush Mount**  
(General Lighting)

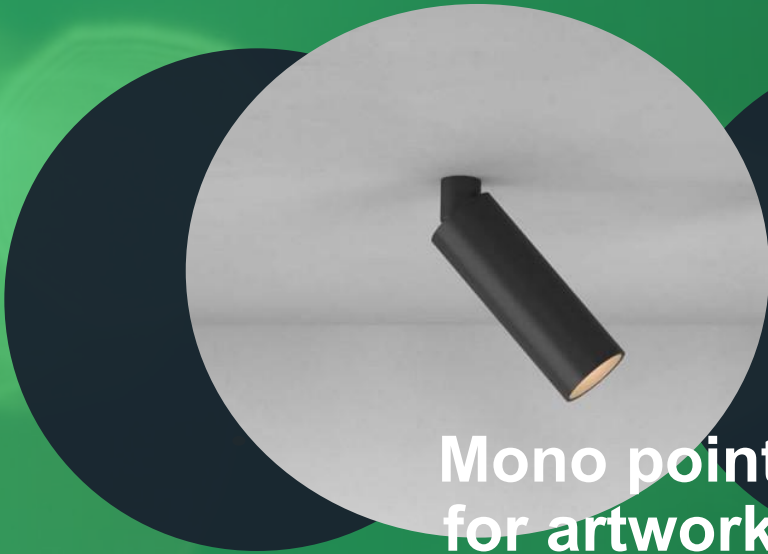
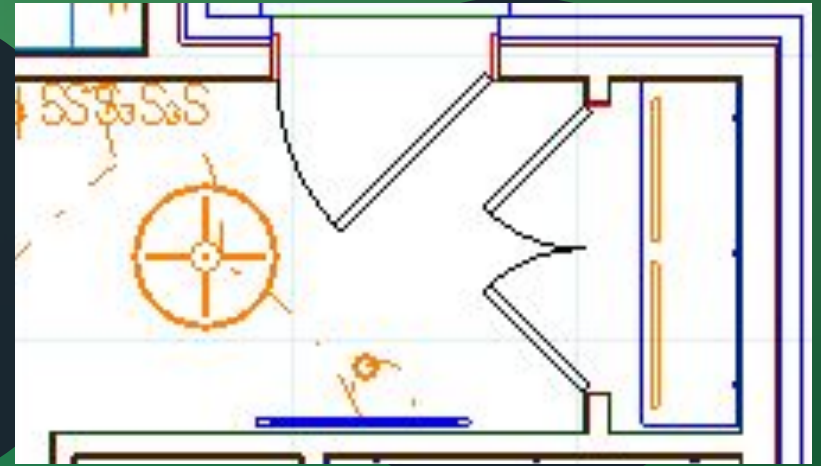

**Mono point  
for artwork**  
(Accent Light)



**LED with Sensor  
in Closet**  
(Task Light)

# Kitchen



**Pendant Light  
at countertop**  
(Task Light)

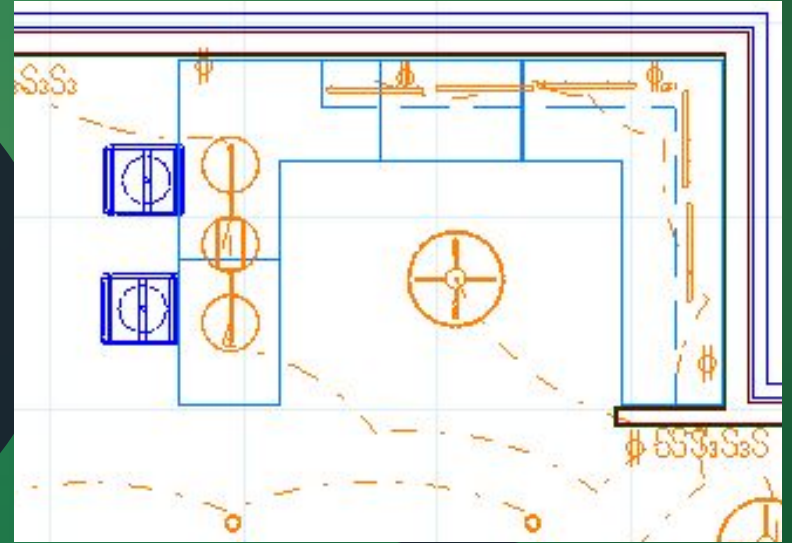

**Flush Mount  
at Ceiling**  
(General Light)



**LED strip under  
cabinet**  
(Task Light)

# Dining Room

**Chandelier above  
Dining Table**  
(Task Light)

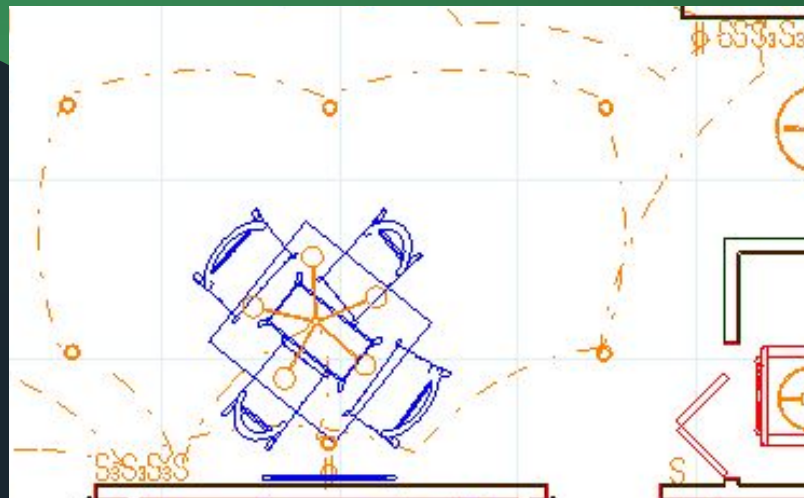
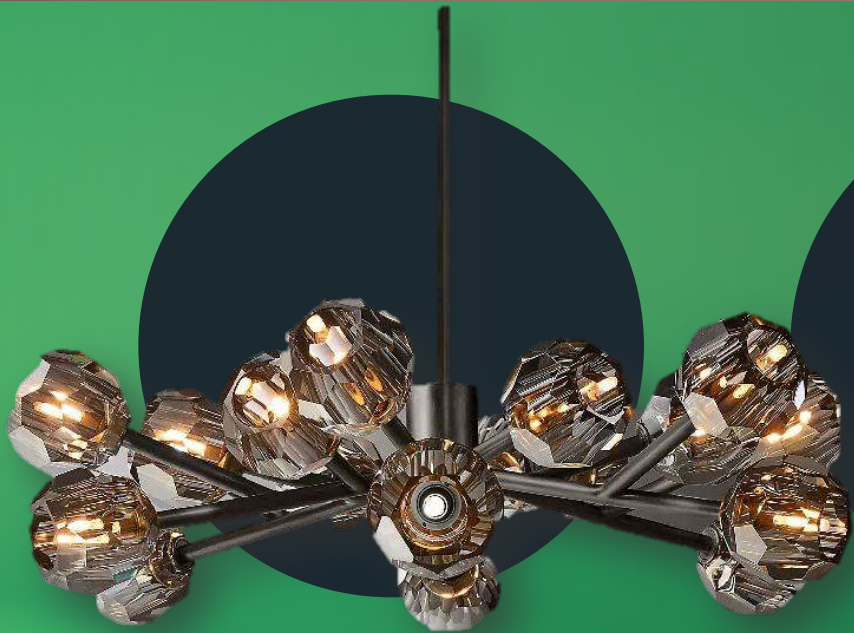

**Recessed Light**  
(General Light)



**Mono point  
for artwork**  
(Accent Light)



# Living Room



**Chandelier above  
Coffee Table**  
(General Light)

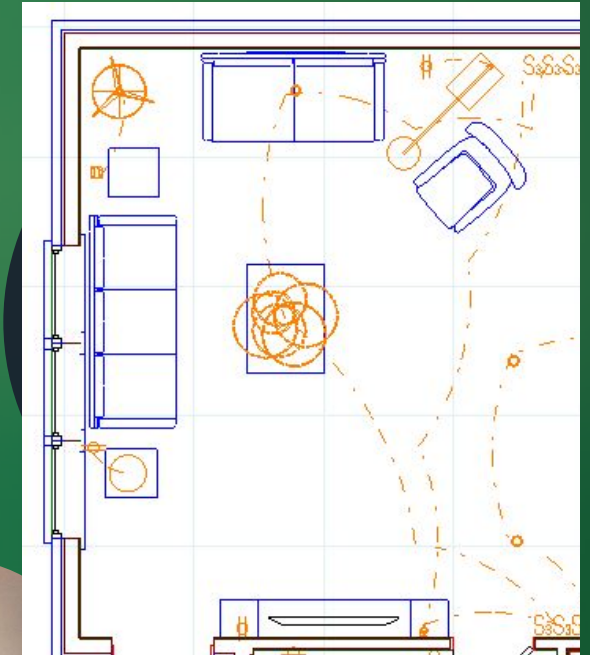

**Floor Luminaire  
at the corner**  
(General + Task Light)



**Table Luminaire  
on side table**  
(General + Task Light)



**Floor Luminaire**  
(Task Light)



**Scone  
next to TV**  
(Task Light)



**Mono point for  
artwork**  
(Accent Light)

# Bedroom



**Chandelier**  
(General Light)

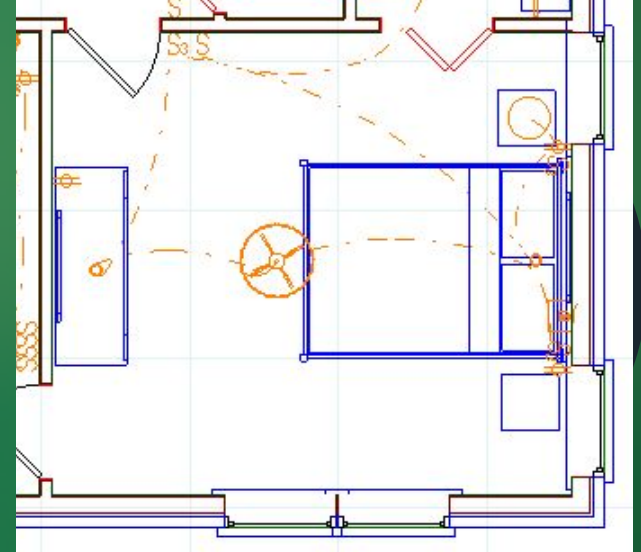

**Table Luminaire  
on Night stand**  
(General + Task Light)

**Sconce with  
Reading Light**  
(General + Task Light)



**Mono point  
for artwork**  
(Accent Light)

# Den/ Office

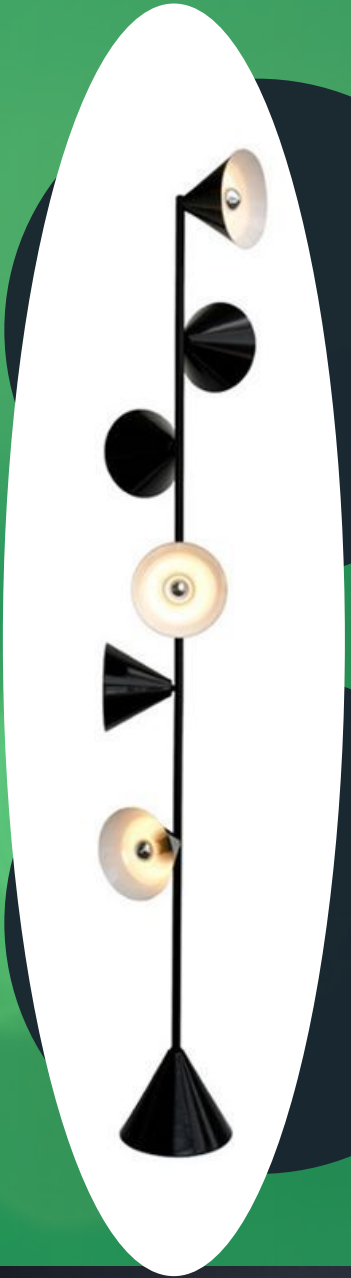

**Floor Luminaires**  
(Task/ General Light)



**Flush Mount  
with mono point**  
(General + Accent Light)

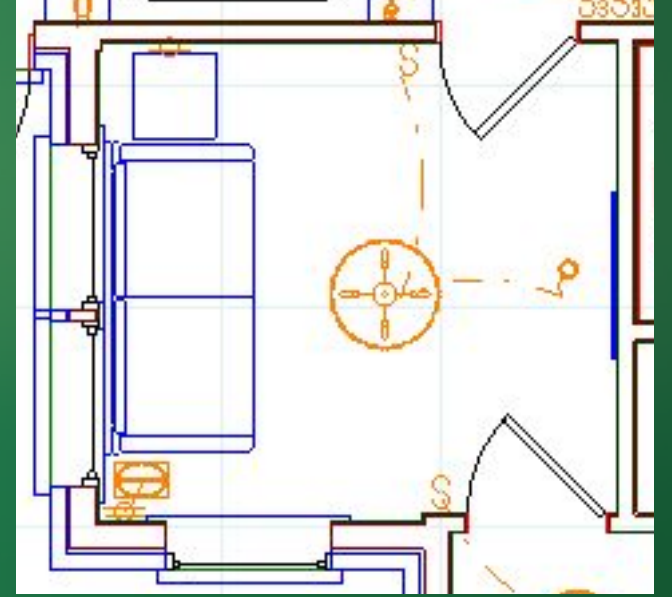

# Bathroom

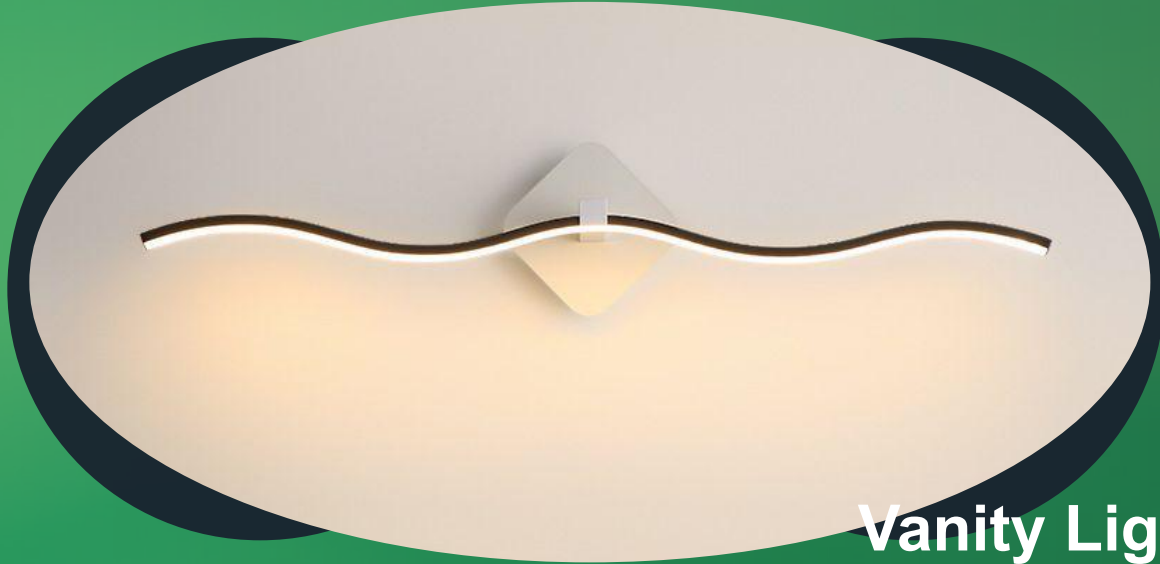

**Vanity Light**  
(Task Light)

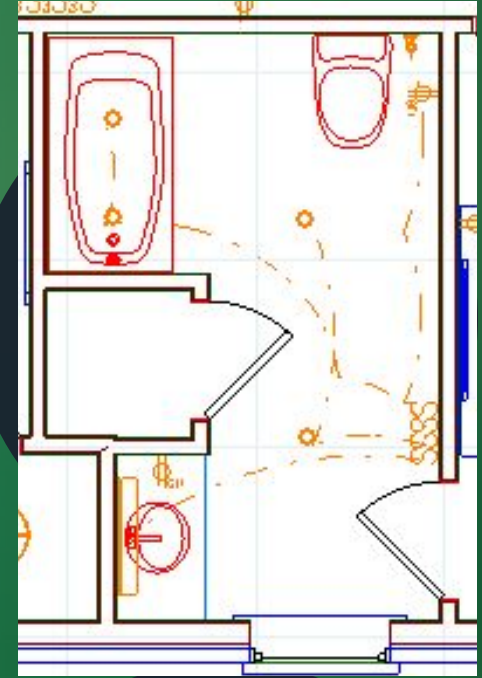

**Sconce next  
to toilet**  
(Task Light)



**Waterproof  
Recessed Light**  
(General Light)

# Closets

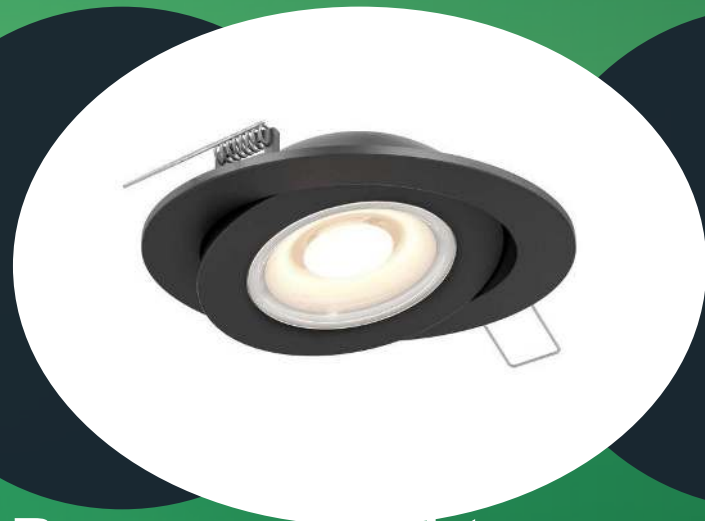

**Recessed Light**  
(General Light)

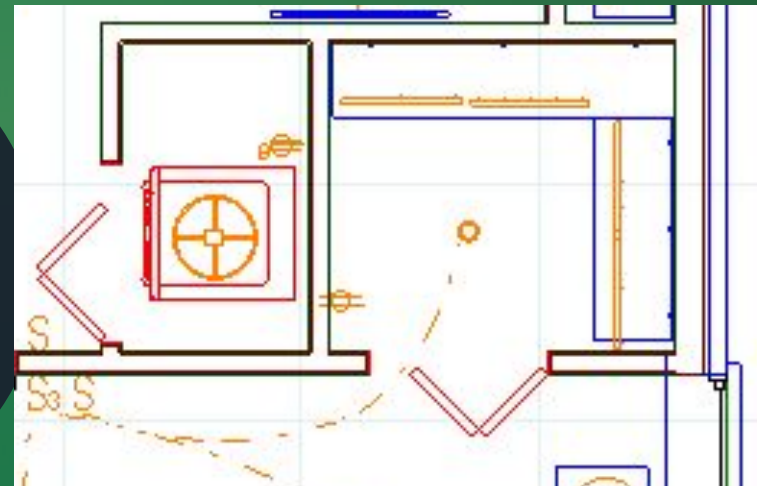

**LED with Sensor**  
below the shelves  
(Task Light)

*Thank You*

